

SET TO BREAK THE MOLD. AGAIN.





CAPRI

EXTENDED EXCURSIONS
IN LUXURY AND COMFORT

CAPRI

There are few yachts in the world that cruise as comfortably at sea as the new Capri line from Uniesse. A flybridge motoryacht designed like no other. She offers the feeling of a luxurious mansion at sea in all respects – perfect for family and friends.



CAPRI 6 >



CAPRI 7 >



CAPRI 8 >



CAPRI 7

2024





5 CAPRI 7







8 CAPRI 7























18 CAPRI 7





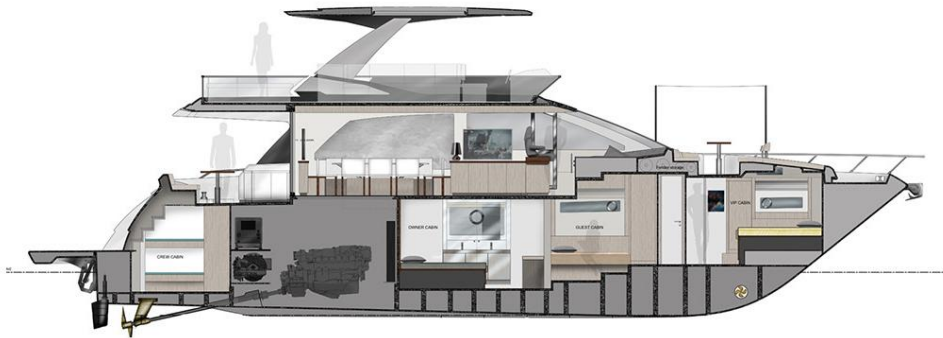
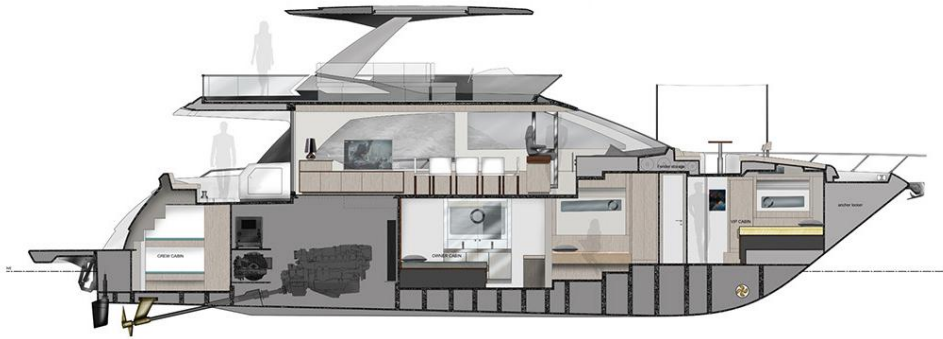



SPECIFICATIONS

PRINCIPAL SPECIFICATIONS

Length overall	20.87 m / 68' 5" ft
Length ISO 8666	19.96 m / 65' 6" ft
Beam – (maximum)	5.40 m / 17' 7" ft
Depth under propellers	1.54 m / 5' 1" ft
Full load displacement	42,000 kg / 92,600 lbs
Light displacement	35,000 kg / 77,000 lbs
Persons	18
Beds	6/8 – +2 crew
CE Omologation	A

FUEL . WATER . ENGINE

Fuel tank capacity	4,550 litri / 1200 US gals
Fresh water tank	1,220 litri / 322 US gals
Grey water tank	300 litri / 79 US gals
Black water tank	300 litri / 79 US gals
Standard engines	MAN 2 x V8 1300 HP / Shaft
Optional engines	MAN 2 x V12 1400 HP / Shaft
Optional engines	MAN 2 x V12 1550 HP / Shaft
Max Power	2x1140 KW
MAX speed	33 – 37 knots



uniesse

WWW.UNIESE.COM +1 (305) 740-5199